



s.55 KFE

1/4"
ISO 228
cap & strap

Many HVAC applications require a blowdown valve to drain water from the strainer.

RuB's new s.55 cap & strap valve is designed with a full port for maximum flow.

Because of the O-ring stem seal design, no maintenance is ever required. 3/4" thread gives the possibility to easily fit a hose holder available as option, for the connection of a waste water collection pipe.



QUALITY

- No metal-to-metal moving parts
- No maintenance ever required
- Handle clearly shows ball position
- Silicone-free lubricant on all seals
- Chrome plated brass ball for longer life
- Each valve is seal tested for maximum safety
- Double seal system

BODY

- Hot forged sand blasted, unplated brass body and cap sealed with Loctite® or equivalent thread sealant
- Finest brass according to EN 12165 and EN 12164 specifications

STEM

- Blowout-proof brass stem with EPDM O-ring
- Maintenance-free, double EPDM O-ring at the stem for maximum safety

SEALING

- Pure PTFE self-lubricating seats with flexible-lip design

THREADS

- 1/4" ISO 228 parallel male thread by 3/4" ISO 228 thread closed by cap

FLOW

- Full port for maximum flow

HANDLE

- Reinforced nylon black wedge handle removable with valve in service

WORKING PRESSURE & TEMPERATURE

- 40 bar (600 PSI) non-shock cold working pressure
- -20°C to +90°C (-4°F to +200°F)
- +120°C screw driver and wrench operated version
- **WARNING:** freezing of the fluid in the installation may severely damage the valve

APPROVED BY OR IN COMPLIANCE WITH

- EAC – Declaration of conformity (Russia, Kazakhstan, Belarus)
- RoHS Compliant (EU)

NOTE: approvals apply to specific configurations/sizes only.

OPTIONS

- Screw driver or wrench operated
- Nylon wedge handle yellow, red or green
- Grey wedge handle in Grivory® – high performing polymer
- 1/4" NPT taper ANSI B.1.20.1 male thread by 3/4"NH hose thread
- Hose holder for connection of waste water collection pipe
- Seal washer on 1/4" ISO 228 parallel male thread
- Additional connection options on demand



s.55 KFE XCES55KFE - 5813

Each user should perform his own tests to find out the suitability for his particular application. BONOMI INDUSTRIES makes no warranty, express or implied, as to the shape, fit or function of a product for any application. Contact us or consult with your supplier for additional information on the suitability of the BONOMI INDUSTRIES products with your specific field of use.



PLUMBING

Part description		Q.ty	Material
1	Unplated body	1	CW617N
2	Body seat	1	PTFE
3	Chrome plated ball	1	CW617N
4	Retainer seat	1	PTFE
5	Unplated retainer nut	1	CW617N
6	Black strap	1	Plastic
7	Unplated cap	1	CW617N
8	Seal cap	1	EPDM
9	Black handle	1	Nylon glass filled 30%
10	Zinc plated screw	1	CB4FF (EN10263-2)
11	Unplated stem	1	CW617N
12	O-Ring	1	EPDM

Code	S55B00
D (inch)	1/4"
D1 (mm)	3/4"
DN (mm)	8
E (mm)	19
I (mm)	10
G (mm)	19.1
L (mm)	39
A (mm)	22.5
H (mm)	32
Kv (m3/h)	5.8

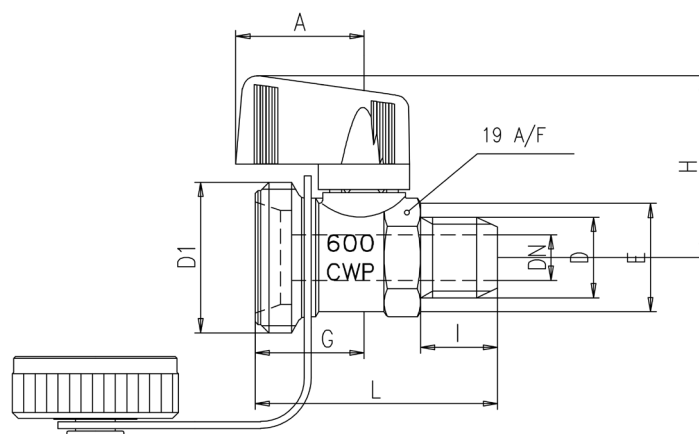
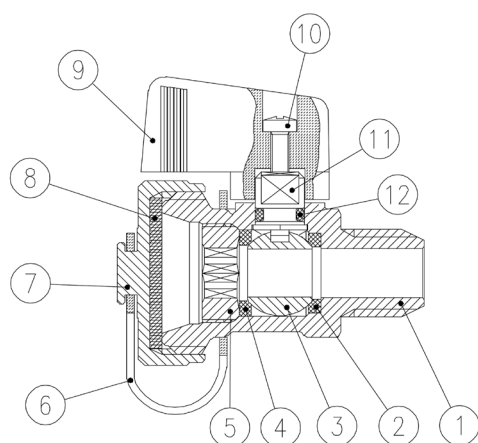

DN shows the nominal flow diameter.

PRESSURE-TEMPERATURE CHART

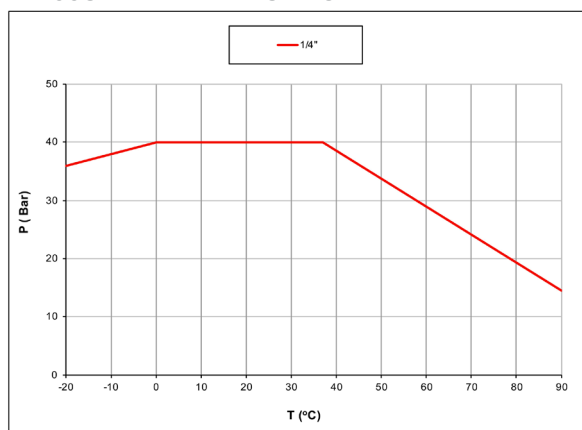

PRESSURE DROP CHART

