



s.34 M/F

**Male/Female
1/8" - 1/2"
ISO 228 mini ball valve, suitable for panel mounting**



QUALITY

- Each valve is seal tested for maximum safety
- Dual sealing system allows valve to be operated in either direction making installation easier
- No metal-to-metal moving parts
- No maintenance ever required
- Handle clearly shows ball position
- Silicone-free lubricant on all seals
- Chrome plated brass ball for longer life

BODY

- One piece drawn sand blasted brass body incorporating stem neck which provides excellent guidance of the stem
- Finest brass according to EN 12164 specification

STEM

- Maintenance-free, double FPM O-rings at the stem for maximum safety

SEALING

- Pure PTFE self-lubricating seats with flexible-lip design

THREADS

- ISO 228 parallel male by female threads

HANDLE

- Lever and T-handle clearly show ball position
- Nylon black lever or T-handle removable with valve in service

WORKING PRESSURE & TEMPERATURE

- 15 bar (200 PSI) non-shock cold working pressure
- -20°C to +90°C (-4°F to +200°F)
- **WARNING:** freezing of the fluid in the installation may severely damage the valve

PED DIRECTIVE

- The product meets the requirements of PED Directive 2014/68/UE and according to art.4 par.3, it does not require CE marking

APPROVED BY OR IN COMPLIANCE WITH

- RoHS Compliant (EU)
- EAC – Declaration of conformity (Russia, Kazakhstan, Belarus)

NOTE: approvals apply to specific configurations/sizes only.

OPTIONS

- Female by female threads
- Screw driver or wrench operated
- Yellow lever or T-handle



s.34 MF XCES34M - 5813

Each user should perform his own tests to find out the suitability for his particular application. BONOMI INDUSTRIES makes no warranty, express or implied, as to the shape, fit or function of a product for any application. Contact us or consult with your supplier for additional information on the suitability of the BONOMI INDUSTRIES products with your specific field of use.



PNEUMATIC

Part description		Q.ty	Material
1	Chrome plated body	1	CW617N
2	Retainer nut	1	CW617N
3	Retainer seat	1	PTFE
4	Chrome plated ball	1	CW617N
5	Body seat	1	PTFE
6	Unplated stem	1	CW617N
7	Pin	1	1.4301 / AISI304
8	Zinc plated screw	1	CB4FF (EN10263-2)
9	O-Ring	2	FPM
10	Black handle	1	Nylon glass filled 30%

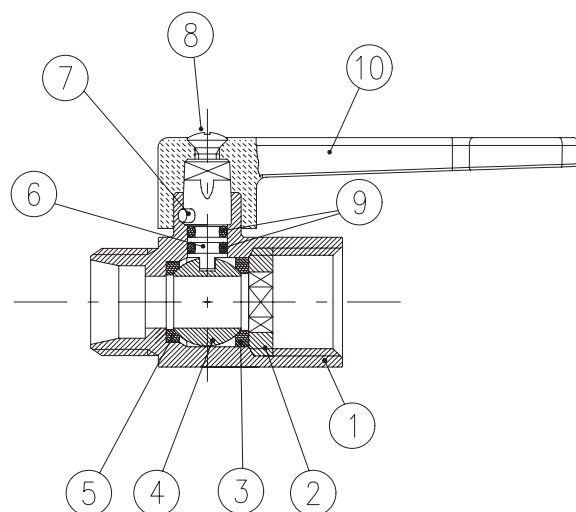

Code	S34AM0	S34BM0	S34CM0	S34DM0
D (inch)	1/8"	1/4"	3/8"	1/2"
DN (mm)	5	8	8	10
I (mm)	10	11	11	13
I 1 (mm)	9.5	9.5	9.5	13
L (mm)	41.5	41.5	41.5	49
G (mm)	22	22	22	26
A (mm)	72	72	72	72
H (mm)	30.5	30.5	30.5	32.5
CH (mm)	21	21	21	25
Kv (m³/h)	1.7	4.2	3.6	5

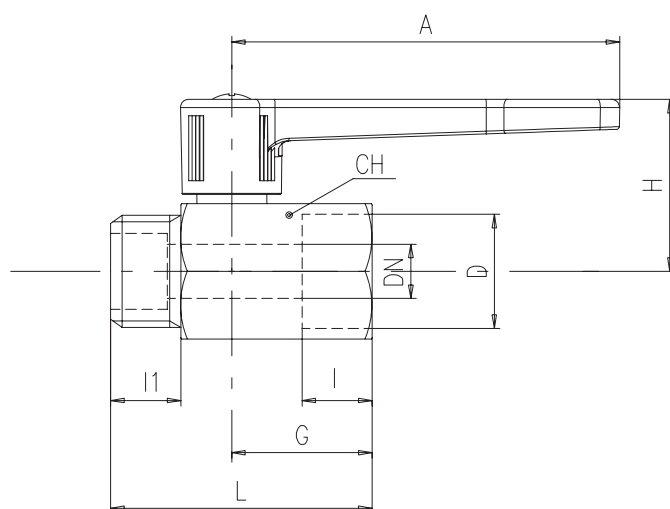

DN shows the nominal flow diameter.

PRESSURE-TEMPERATURE CHART

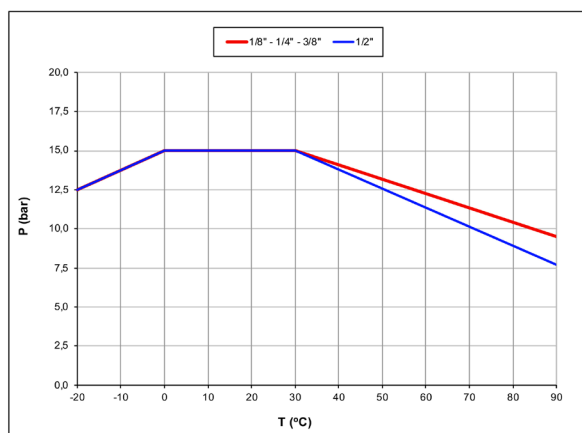

PRESSURE DROP CHART

