

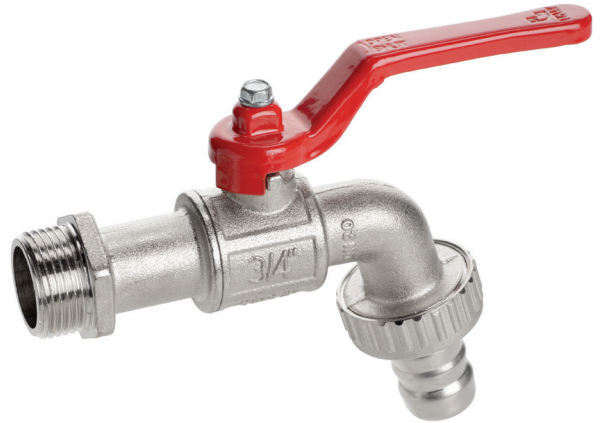

S.142 bib-cock

3/8" - 1"
with 3/4" outlet and hose



QUALITY

- Chrome plated brass ball for longer life

BODY

- Hot forged sand blasted nickel plated brass body
- Angle pattern ball bib-cock with hose fitting
- Copper alloy brass according to EN 12165 and EN 12164 specifications

STEM

- Maintenance-free, double O-rings (FPM and NBR) at the stem for maximum safety

SEALING

- Pure PTFE seats

THREADS

- UNI ISO 228 male inlet thread
- 3/4" threaded outlet complete with hose

HANDLE

- Enameled red steel handle
- **WARNING:** do not exceed reasonable temperature and/or electrical load
- Handle removable with valve in service

WORKING PRESSURE & TEMPERATURE

- 15 bar up to 3/4", 12 bar 1" non-shock cold working pressure
- -20°C to +80°C
- **WARNING:** freezing of the fluid in the installation may severely damage the valve

PED DIRECTIVE

- The product meets the requirements of PED Directive 2014/68/UE and according to art.4 par.3, it does not require CE marking

APPROVED BY OR IN COMPLIANCE WITH

- EAC – Declaration of conformity (Russia, Kazakhstan, Belarus)

NOTE: approvals apply to specific configurations/sizes only.

s.142 XCE142 - 5813

Each user should perform his own tests to find out the suitability for his particular application. BONOMI INDUSTRIES makes no warranty, express or implied, as to the shape, fit or function of a product for any application. Contact us or consult with your supplier for additional information on the suitability of the BONOMI INDUSTRIES products with your specific field of use.



PLUMBING

	Part description	Q.ty	Material
1	Nickel plated body	1	CW617N
2	Seat	2	PTFE
3	Chrome plated ball	1	CW614N
4	Nickel plated end-cap	1	CW617N
5	Stem O-Ring design	1	CW614N
6	O-Ring	1	FPM
7	O-Ring	1	NBR
8	Zinc plated screw	1	CB4 (EN10263-2)
9	Enameled red handle	1	DC04 (EN10130)
10	Washer	1	PVC rubber
11	Nickel plated nut	1	CW617N
12	Nickel plated hose	1	CW617N
13	Infuser	1	Vestolen

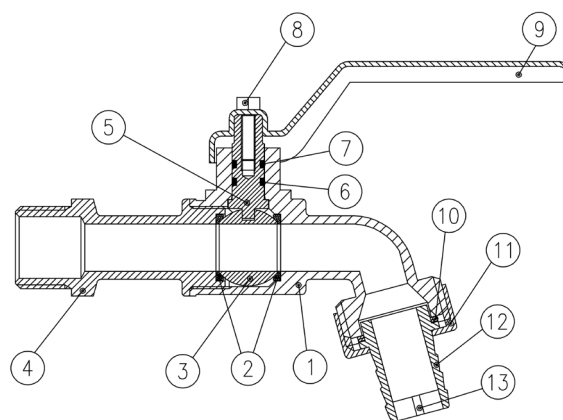

Code	142C0P	142D0P	142E0P	142F0P
D (inch)	3/8"	1/2"	3/4"	1"
DN (mm)	10	12	12	15
B (mm)	53	53	61	65
L (mm)	135	137	148.5	158
A (mm)	80	80	88.5	88.5
H (mm)	93	93	108.5	126

