



# s.126 M NPT

Female/Female  
1/2" - 2"

NPT swing check valve with metal seals



EAC

## QUALITY

- Suitable for domestic, industrial, pneumatic and hydraulic installations
- Robust construction
- Inspection cap

## BODY

- Hot forged brass body

## SEALING

- Metal to metal sealing

## THREADS

- NPT taper ANSI B.1.20.1 female by female threads

## WORKING PRESSURE & TEMPERATURE

- 145 psi (10 bar) non-shock cold working pressure
- +32°F to +212°F (0°C to +100°C)
- **WARNING:** freezing of the fluid in the installation may severely damage the valve

## APPROVED BY OR IN COMPLIANCE WITH

- EAC – Declaration of conformity (Russia, Kazakhstan, Belarus)

**NOTE:** approvals apply to specific configurations/sizes only.

s.126 M NPT XCE126MN - 5813

Each user should perform his own tests to find out the suitability for his particular application. BONOMI INDUSTRIES makes no warranty, express or implied, as to the shape, fit or function of a product for any application. Contact us or consult with your supplier for additional information on the suitability of the BONOMI INDUSTRIES products with your specific field of use.



Part description		Q.ty	Material
1	Unplated body	1	CW617N
2	Unplated bonnet	1	CW617N
3	Unplated sealing disc	1	CW617N

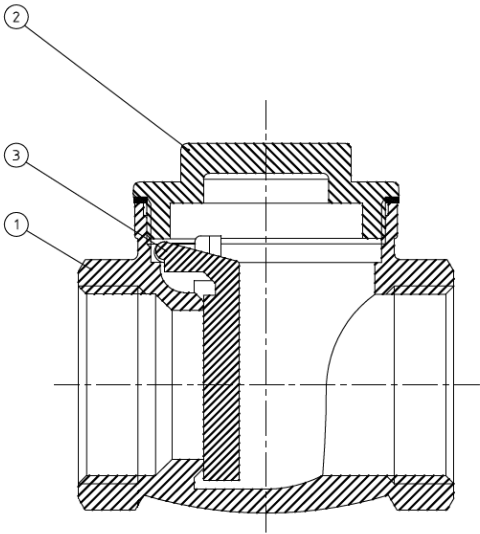

Code	126D4M	126E4M	126F4M	126G4M	126H4M	126DI4M
Size (inch)	1/2"	3/4"	1"	1 1/4"	1 1/2"	2"
ØA (inch)	0,59	0,78	0,98	1,29	1,45	1,85
B (inch)	1,81	2	2,4	2,87	3,34	3,7
C (inch)	1,85	2,08	2,48	2,91	3,42	3,81
CH (inch)	0,98	1,22	1,49	1,85	2,12	2,63
PN (psi)	145	145	145	145	145	145

