



s.124

1/2" - 4"
ISO 228
foot valve



EAC

QUALITY

- Suitable for domestic, industrial, pneumatic and hydraulic installations
- Valve will perform its duty no matter if installed horizontally, vertically or half way
- Strong configuration

BODY

- Hot forged brass body
- * Stainless steel filter
- * Filtration degree 2400 µm

SEALING

- Soft seat for positive shut-off

THREADS

- ISO 228 female parallel thread

WORKING PRESSURE & TEMPERATURE

- 10 bar up to 1", 8 bar from 1 1/4" to 2", 6 Bar over 2" non-shock cold working pressure
- 0°C to +90°C (+32°F to +194°F)
- **WARNING:** freezing of the fluid in the installation may severely damage the valve

PED DIRECTIVE

- The product described in this document meets the requirements of PED Directive 2014/68/UE and according to art.4 par.3, it does not require CE marking; it cannot be used with dangerous gases in sizes larger than 25mm

APPROVED BY OR IN COMPLIANCE WITH

- EAC – Declaration of conformity (Russia, Kazakhstan, Belarus)

NOTE: approvals apply to specific configurations/sizes only.

s.124 XCE124 - 5813

Each user should perform his own tests to find out the suitability for his particular application. BONOMI INDUSTRIES makes no warranty, express or implied, as to the shape, fit or function of a product for any application. Contact us or consult with your supplier for additional information on the suitability of the BONOMI INDUSTRIES products with your specific field of use.



PLUMBING

Part description		Q.ty	Material
1	Body	1	CW617N
2	Seat	1	CW617N
3	Seal	1	NBR
4	Gasket	1	Fibre
5	Retainer	1	CW617N
6	Strainer	1	AISI304 (1.4301)

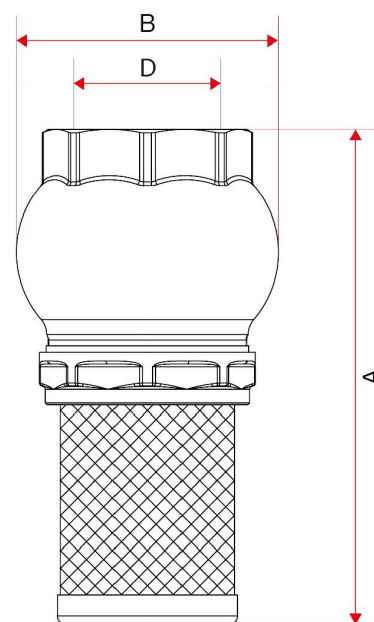
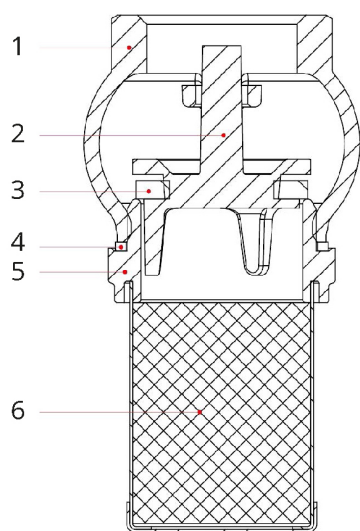

Code	124D00	1,24E+02	124F00	124G00	124H00	124I00	124L00	124M00	124N00
D (inch)	1/2"	3/4"	1"	1 1/4"	1 1/2"	2"	2 1/2"	3"	4"
A (mm)	68,5	84,5	99,00	113,5	112,5	142,5	168,00	194,5	216,5
B (mm)	39,00	45,00	51,00	61,00	68,5	80,00	100,00	121,00	145,00
PN (Kg/cm ²)	10,00	10,00	10,00	8,00	8,00	8,00	6,00	6,00	6,00