

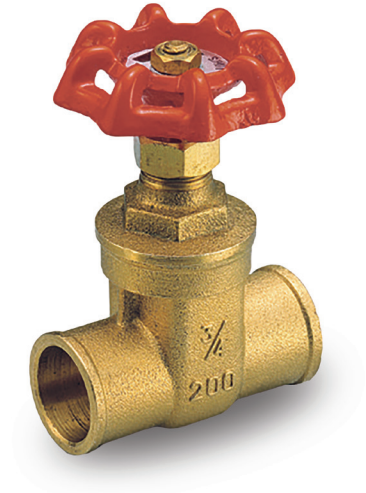

# s.115 sweat end

**Female/Female  
1/2" - 2"  
heavy pattern gate valve**



**EAC**

## QUALITY

- Suitable for water-works, domestic and agricultural installations
- Non rising stem suitable to most difficult applications

## BODY

- Low pressure drop
- Finely cast sand blasted heavy brass body

## STEM

- High performance PTFE stem seal

## CONNECTIONS

- Solder end connections

## HANDLE

- Strong cast aluminum hand-wheel
- **WARNING:** do not exceed reasonable temperature and/or electrical load

## WORKING PRESSURE & TEMPERATURE

- 200 PSI (for solder joints rating see table 1) non-shock cold working pressure
- -4°F to +200°F (for solder joints rating see table 1)
- **WARNING:** freezing of the fluid in the installation may severely damage the valve

## APPROVED BY OR IN COMPLIANCE WITH

- EAC – Declaration of conformity (Russia, Kazakhstan, Belarus)

**NOTE:** approvals apply to specific configurations/sizes only.

## OPTIONS

- s.114 NPT female by female taper threads

## s.115 sweat end XCE115 - 5813

Each user should perform his own tests to find out the suitability for his particular application. BONOMI INDUSTRIES makes no warranty, express or implied, as to the shape, fit or function of a product for any application. Contact us or consult with your supplier for additional information on the suitability of the BONOMI INDUSTRIES products with your specific field of use.



Part description		Q.ty	Material
1	Body	1	CW617N
2	Gate	1	CW617N
3	Stem	1	CW617N
4	Body cap sealing	1	PTFE
5	Cap	1	CW617N
6	Stem ring	1	CW617N
7	Packing gland seal	1	PTFE
8	Packing gland	1	CW617N
9	Packing gland nut	1	CW617N
10	Red round handle	1	Steel
11	Disc	1	Aluminum
12	Handle nut	1	CW617N

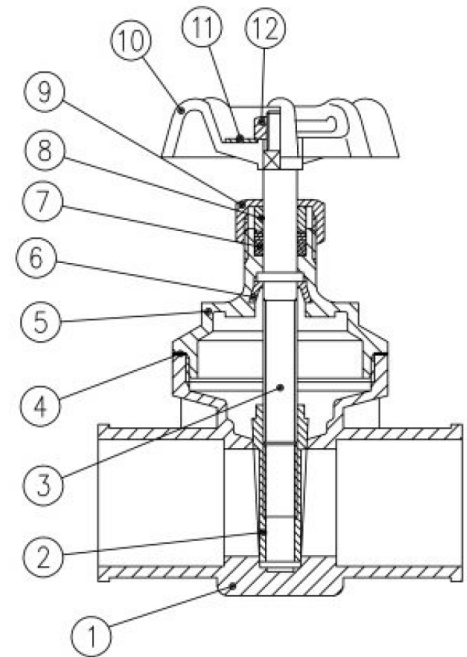

Code		115D00	115E00	115F00	115G00	115H00	115I00
Size (inch)	Nominal	1/2"	3/4"	1"	1 1/4"	1 1/2"	2"
	Actual	0,630	0,878	1,130	1,378	1,630	2,130
DN (inch)		0,500	0,748	1,000	1,248	1,500	2,000
I (inch)		0,492	0,748	0,905	0,964	1,102	1,338
L (inch)		1,772	2,362	2,716	3,031	3,386	4,016
A (inch)		2,165	2,165	2,362	2,835	3,150	3,937
H (inch)		2,815	3,130	3,661	4,331	4,862	6,083
PSI		200	200	200	200	200	200

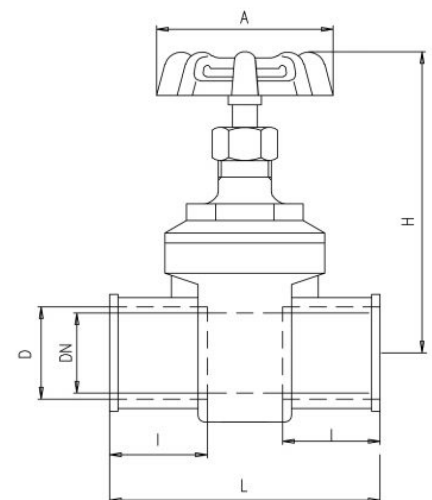

TABLE 1 PRESSURE - TEMPERATURE RATINGS										
Joining material	Melting range degrees		Working temperature degrees		Maximum working gauge pressure					
					Size 1/8" - 1"		Size 1 1/4" - 2"		Size 2 1/2" - 4"	
	°F	°C	°F	°C	PSI	kPa	PSI	kPa	PSI	kPa
50-50 tin-lead solder* ASTM B32 alloy grade 50 A	361/421	185/215	0/+100	-18/+38	200	1400	176	1200	150	1050
			0/+150	-18/+66	150	1050	125	850	100	700
			0/+200	-18/+93	100	700	90	600	75	500
			0/+250	-18/+121	85	600	75	500	50	350
95-5 tin-antimony solder ASTM B32 alloy grade 95TA	450/464	230/240	0/+100	-18/+38	500	3500	400	2800	300	2100
			0/+150	-18/+66	400	2800	350	2400	275	2000
			0/+200	-18/+93	300	2100	250	1700	200	1400
			0/+250	-18/+121	200	1400	175	1200	150	1050

### Note:

Above stated limits are not imposed by the valve, but by the strength of the soldering joint according to ASME B16.22.

\* This alloy contains more than 0,2% lead and, according to certain specifications, cannot be used for potable water or other foods.