



s.114 NPT

**Female/Female
1/2" - 4"
heavy pattern gate valve**



EAC

QUALITY

- Suitable for water-works, domestic and agricultural installations
- Non rising stem suitable to most difficult applications

BODY

- Low pressure drop
- Finely cast sand blasted heavy brass body

STEM

- High performance PTFE stem seal

THREADS

- NPT female by female taper threads

HANDLE

- Strong cast aluminum hand-wheel
- **WARNING:** do not exceed reasonable temperature and/or electrical load

WORKING PRESSURE & TEMPERATURE

- 200 PSI non-shock cold working pressure
- -4°F to +350°F
- **WARNING:** freezing of the fluid in the installation may severely damage the valve

APPROVED BY OR IN COMPLIANCE WITH

- EAC – Declaration of conformity (Russia, Kazakhstan, Belarus)

NOTE: approvals apply to specific configurations/sizes only.

s.114 XCE114 - 5813

Each user should perform his own tests to find out the suitability for his particular application. BONOMI INDUSTRIES makes no warranty, express or implied, as to the shape, fit or function of a product for any application. Contact us or consult with your supplier for additional information on the suitability of the BONOMI INDUSTRIES products with your specific field of use.



	Part description	Q.ty	Material
1	Body	1	CW617N
2	Gate	1	CW617N
3	Stem	1	CW617N
4	Body cap sealing	1	PTFE
5	Cap	1	CW617N
6	Stem ring	1	CW617N
7	Packing gland seal	1	PTFE
8	Packing gland	1	CW617N
9	Packing gland nut	1	CW617N
10	Red round handle	1	Steel
11	Disc	1	Aluminum
12	Handle nut	1	CW617N

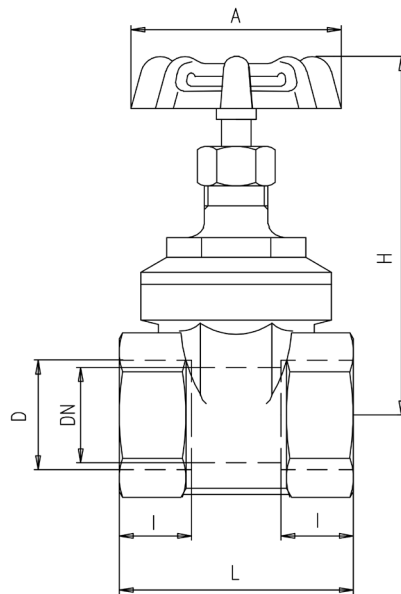
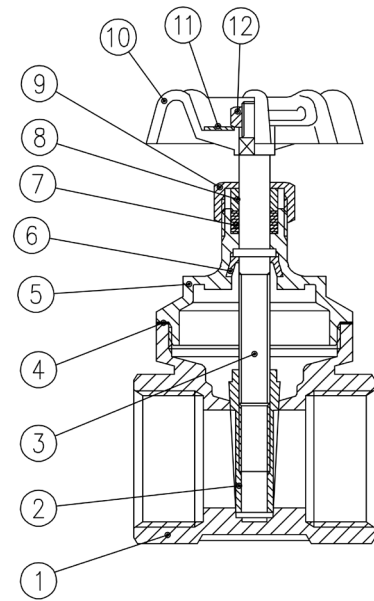

Code	114D41	114E41	114F41	114G41	114H41	114I41	114L41	114M41	114N41
Size (inch)	1/2"	3/4"	1"	1 1/4"	1 1/2"	2"	2 1/2"	3"	4"
DN (inch)	0,504	0,669	0,827	1,063	1,339	1,772	2,205	2,667	3,543
I (inch)	0,449	0,492	0,559	0,657	0,669	0,728	0,925	1,004	1,181
L (inch)	1,693	1,772	2,047	2,323	2,48	2,716	3,465	3,74	4,488
A (inch)	2,165	2,165	2,362	2,835	2,835	3,15	3,937	4,331	5,118
H (inch)	2,795	2,992	3,445	4,055	4,475	5,256	6,437	7,48	9,252
PSI	200	200	200	200	200	200	200	200	200