



s.111

**Female/Female
1/4" - 4"**

ISO 228, heavy pattern gate valve



EAC

QUALITY

- Suitable for water-works, domestic and agricultural installations
- Heavy configuration suitable to most difficult applications

BODY

- Hot forged sand blasted unplated brass body
- Low pressure drop

STEM

- High performance EPDM stem seal

THREADS

- ISO 228 parallel female by female threads

HANDLE

- Strong red coated steel hand-wheel
- Zinc plated steel top nut
- **WARNING:** do not exceed reasonable temperature and/or electrical load

WORKING PRESSURE & TEMPERATURE

- 20 bar (300 PSI) non-shock cold working pressure
- -10°C to +80°C (+15°F to +175°F)
- **WARNING:** freezing of the fluid in the installation may severely damage the valve

PED DIRECTIVE

- The product described in this document meets the requirements of PED Directive 2014/68/UE and according to art.4 par.3, it does not require CE marking; it cannot be used with dangerous gases in sizes larger than 25mm; it cannot be used with non-dangerous gases in sizes larger than 50mm

APPROVED BY OR IN COMPLIANCE WITH

- EAC – Declaration of conformity (Russia, Kazakhstan, Belarus)

NOTE: approvals apply to specific configurations/sizes only.

s.111 XCE111 - 5813

Each user should perform his own tests to find out the suitability for his particular application. BONOMI INDUSTRIES makes no warranty, express or implied, as to the shape, fit or function of a product for any application. Contact us or consult with your supplier for additional information on the suitability of the BONOMI INDUSTRIES products with your specific field of use.



PLUMBING

	Part description	Q.ty	Material
1	Body	1	CW617N
2	Gate	1	CB 754S
3	Stem	1	CW614N
4	Body cap sealing	1	Guarnital Fibre
5	Cap	1	CW617N
6	Stem ring	1	CW614N
7	Packing gland seal	1	EPDM90
8	Packing gland	1	CW614N
9	Packing gland nut	1	CW614N
10	Red round handle	1	Steel
11	Handle nut	1	Steel

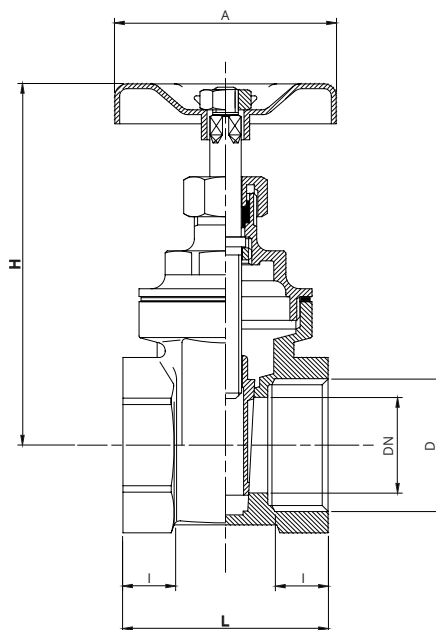
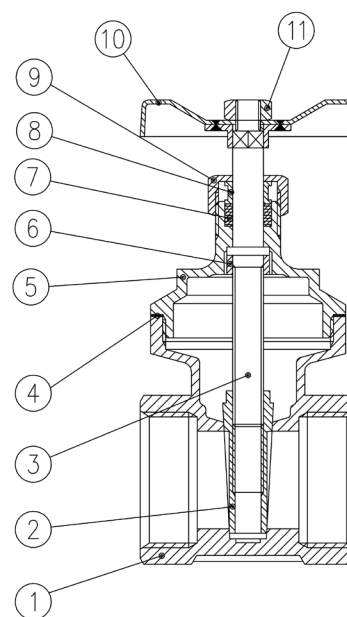

Code	111B00	111C00	111D00	111E00	111F00	111G00	111H00	111I00	111L00	111M00	111N00
D (Size)	1/4"	3/8"	1/2"	3/4"	1"	1 1/4"	1 1/2"	2"	2 1/2"	3"	4"
DN (mm)	11	13	15	19	24	32	37	47	60	72	93
I (mm)	8	8	11	12	14	14	14	16	17	19	22
L (mm)	32	32	43	47	51	57	60	66	74	85	98
A (mm)	45	45	45	50	55	60	70	80	100	100	120
H (mm)	67	67	68	78	91	108	125	143	175	205	235