



s.100 3-way 4 seats T-port

Female/Female/Female
1/4" - 2", ISO 228



EAC

QUALITY

- Chrome plated brass ball for longer life
- UNI 8858 cycle and torque tests performed

BODY

- Hot forged sand blasted nickel plated brass body and caps
- 3- way T design allows complete range of flow handling applications
- Copper alloy brass according to EN 12165 and EN 12164 specifications

STEM

- Maintenance-free, double NBR O-rings at the stem for maximum safety

SEALING

- Four seats design limits mixture among various fluids in the system
- PTFE seats

THREADS

- ISO 228 female threads

FLOW

- Extra port for lowest pressure drop

WORKING PRESSURE & TEMPERATURE

- See non- shock cold working pressure on chart
- -10°C to + 120°C (+15°F to +250°F)
- **WARNING:** freezing of the fluid in the installation may severely damage the valve

PED DIRECTIVE

- The product described in this document meets the requirements of PED Directive 2014/68/UE and according to art.4 par.3, it does not require CE marking; it cannot be used with dangerous gases in sizes larger than 25mm; it cannot be used with non-dangerous gases in size larger than 32 mm

APPROVED BY OR IN COMPLIANCE WITH

- EAC – Declaration of conformity (Russia, Kazakhstan, Belarus)

NOTE: approvals apply to specific configurations/ sizes only.

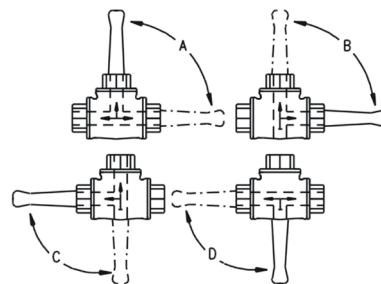

s.100 3-way T port

s.100 XCE100 - 5813

Each user should perform his own tests to find out the suitability for his particular application. BONOMI INDUSTRIES makes no warranty, express or implied, as to the shape, fit or function of a product for any application. Contact us or consult with your supplier for additional information on the suitability of the BONOMI INDUSTRIES products with your specific field of use.



	Part description	Q.ty	Material
1	Nickel plated body	1	CW617N
2	Seat	4	PTFE
3	Chrome plated ball	1	CW617N
4	Nickel plated end-cap	3	CW617N
5	Nickel plated stem O-ring design	1	CW614N
6	Nickel plated nut	1	CW614N
7	O-Ring	2	NBR
8	Screw	1	Steel
9	Red handle	1	Aluminum

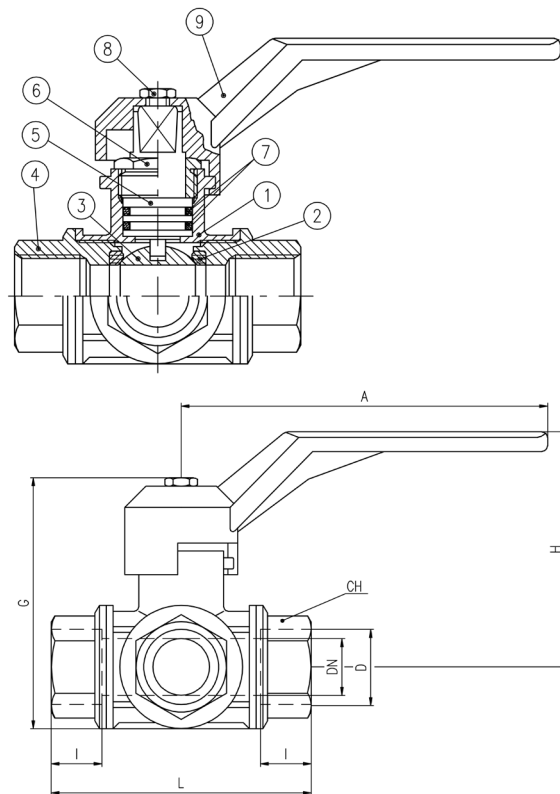

Code	100B00	100C00	100D00	100E00	100F00	100G00	100H00	100I00
D (inch)	1/4"	3/8"	1/2"	3/4"	1"	1 1/4"	1 1/2"	2"
DN (mm)	10	12	14	18	23	29	36	45
I (mm)	19	19	19	23	25	27	31	36
L (mm)	77	77	77	92	104	118	138	162
G (mm)	75	75	75	91	105	115	128	165
A (mm)	125	125	125	145	170	170	170	260
H (mm)	65	65	65	83	96	102	109	139
CH (mm)	22	22	27	34	41	50	57	70
Kv (m³/h)	1.5	2.5	3.5	7.0	12	19.5	37	52

PRESSURE-TEMPERATURE CHART

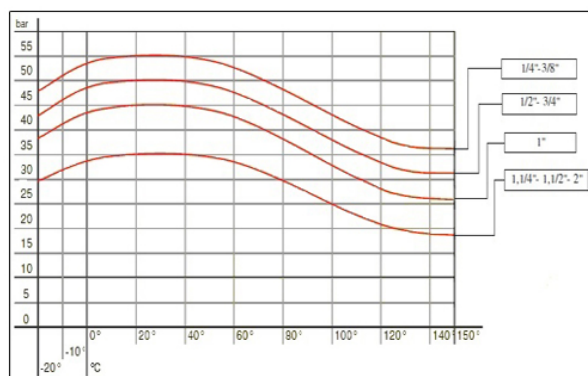

PRESSURE DROP CHART

