

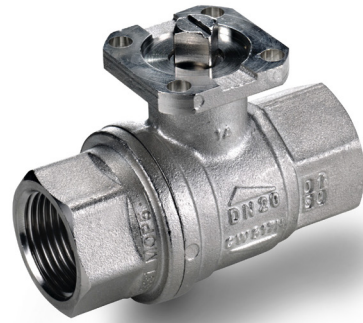

# s.6400LT

**Female/Female**  
**1" - 2"**

**EN 10226-1, ISO 5211, low torque**



## QUALITY

- Dual sealing system allows valve to be operated in either direction making installation easier
- No metal-to-metal moving parts
- No maintenance ever required
- Silicone-free lubricant on all seals
- Chrome plated brass ball for longer life
- 100% seal test guaranteed in according to EN 12266- 1 RATE A

## BODY

- Hot forged sand blasted, nickel plated brass body and cap sealed with Loctite® or equivalent thread sealant
- Integrated ISO 5211 and DIN 3337 mounting flange for universal connection to actuator
- Finest brass according to EN 12165 and EN 12164 specifications

## STEM

- Blowout-proof nickel plated brass stem
- Maintenance-free, double FPM O-rings at the stem for maximum safety

## SEALING

- Reinforced PTFE self-lubricating seats with flexible-lip and wear compensation design

## THREADS

- EN 10226-1, ISO 228 parallel female by female threads

## FLOW

- 100% full port for maximum flow

## OPERATING MECHANISM

- Integrated sturdy ISO 5211 flange allows direct mounting of electric and pneumatic actuators, with no bracket or coupling required. See **RuB** line of electric and pneumatic actuators.

## WORKING PRESSURE & TEMPERATURE

- Shell rating: 40 bar (600 PSI) non shock cold working pressure
- Seat rating: Delta P max permissible 16 bar (230 PSI)
- -20°C to +170°C (-4°F to +350°F)
- **WARNING:** freezing of the fluid in the installation may severely damage the valve

## UPON REQUEST

- Custom design

## PED DIRECTIVE

- According to 2014/68/UE module A: it cannot be used with dangerous gases in sizes larger than 25mm

## APPROVED BY OR IN COMPLIANCE WITH

- RoHS Compliant (EU)
- EAC – Declaration of conformity (Russia, Kazakhstan, Belarus)
- Water Regulations Advisory Scheme (United Kingdom)

**NOTE:** approvals apply to specific configurations/sizes only.

## OPTIONS

- Rack and pinion pneumatic actuator (spring return or double acting)
- Compact power electric actuator for some sizes



# s.6400LT XCES6400LT - 5813

Each user should perform his own tests to find out the suitability for his particular application. BONOMI INDUSTRIES makes no warranty, express or implied, as to the shape, fit or function of a product for any application. Contact us or consult with your supplier for additional information on the suitability of the BONOMI INDUSTRIES products with your specific field of use.



ACTUATION

| Part description |                                  | Q.ty | Material                   |
|------------------|----------------------------------|------|----------------------------|
| 1                | Nickel plated body               | 1    | CW617N                     |
| 2                | Ball seat                        | 2    | PTFE carbo-graphite filled |
| 3                | Chrome plated ball               | 1    | CW617N                     |
| 4                | Nickel plated end-cap            | 1    | CW617N                     |
| 5                | Washer                           | 1    | PTFE carbon filled 25%     |
| 6                | Nickel plated stem O-ring design | 1    | CW617N                     |
| 7                | O-Ring                           | 2    | FPM                        |
| 8                | O-Ring                           | 2    | FPM                        |

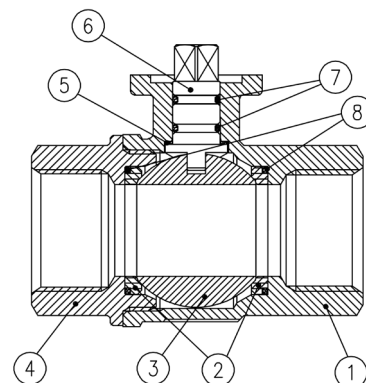

| Code   | S64F00A | S64G00A | S64H00A | S64I00A |
|--|---------|---------|---------|---------|
| D (inch)                                     | 1"      | 1 1/4"  | 1 1/2"  | 2"      |
| DN (mm)                                      | 25      | 32      | 40      | 50      |
| I (mm)                                       | 22.5    | 25      | 26      | 29      |
| L (mm)                                       | 90      | 110     | 120     | 140     |
| G (mm)                                       | 45.5    | 52      | 59      | 67.5    |
| H (mm)                                       | 42.5    | 55.5    | 62      | 69      |
| CH (mm)                                      | 41      | 50      | 55      | 70      |
| ØA (mm)                                      | 36      | 36      | 50      | 50      |
| □B (mm)                                      | 9       | 9       | 11      | 11      |
| C (mm)                                       | 5.6     | 5.6     | 6.6     | 6.6     |
| E (mm)                                       | 25      | 25      | 35      | 35      |
| F (mm)                                       | 8.5     | 8.5     | 10      | 10      |
| Flange connection<br>DIN ISO 522<br>DIN 3337 | F03     | F03     | F05     | F05     |
| Kv (m3/h)                                    | 100     | 155     | 245     | 290     |

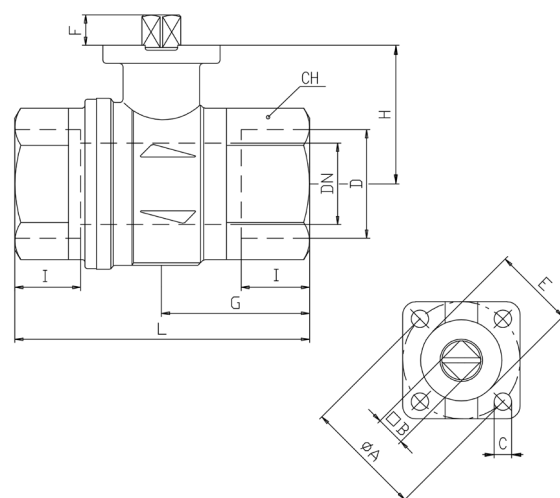

Ball valves are marked CE on end-cap from 1 1/4" to 2" as follow: CE XXCODEXX Cat I-A

## TORQUE FOR ACTUATOR SIZING N.M

| Delta P --> | 0÷6 bar |          | >6÷16 bar |          |
|-------------|---------|----------|-----------|----------|
|             | to open | to close | to open   | to close |
| 1"          | 2,2     | 2,2      | 3,5       | 3,5      |
| 1 1/4"      | 2,5     | 2,5      | 4         | 4        |
| 1 1/2"      | 5,8     | 5,8      | 9,5       | 9,5      |
| 2"          | 7,9     | 7,9      | 13        | 13       |

## TORQUE CORRECTION FACTORS

Valve torque can vary according to operating frequency, temperature and friction characteristics of the media.

If media has more or less friction than water, multiply torque by the following factors:

|  |         |
|--|---------|
| Lubricating oils or liquids                    | 0.8     |
| Dry gases, natural gas                         | 1.5     |
| Slurries or liquids bearing abrasive particles | 1.5÷2.5 |

## PRESSURE-TEMPERATURE CHART

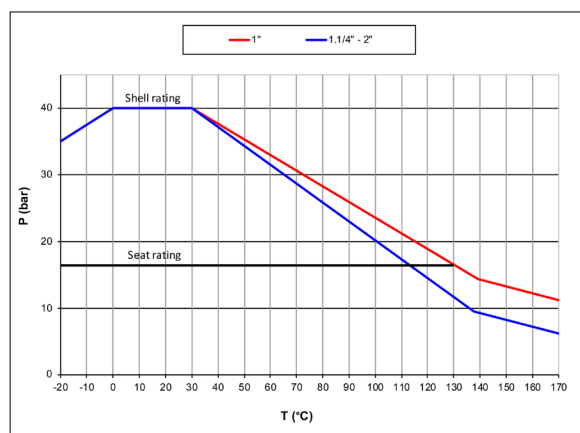

## PRESSURE DROP CHART

