



s.84 BSPT M/F

1/4" - 2"



Quality

- 24h 100% seal test guaranteed
- Dual sealing system allows valve to be operated in either direction making installation easier
- No metal-to-metal moving parts
- No maintenance ever required
- Handle clearly shows ball position
- Silicone-free lubricant on all seals
- Chrome plated brass ball for longer life
- Handle stops on body to avoid stresses at stem

Body

- Hot forged sand blasted, external nickel plated brass body and cap sealed with Loctite® or equivalent thread sealant
- Finest brass according to EN 12165 and EN 12164 specifications

Stem

- Blowout-proof nickel plated brass stem
- Maintenance-free, double FPM O-rings at the stem for maximum safety

Sealing

- Pure PTFE self-lubricating seats with flexible-lip design

Threads

- EN10226-2, ISO 7/1, BS 21 BSPT taper male by female threads

Flow

- Full port to DIN 3357 for maximum flow

Handle

- Geomet® carbon steel handle with thick PVC dip coating. Handle coating offers both thermal and electrical protection
- **WARNING:** do not exceed reasonable temperature and/or electrical load

Working pressure & temperature

- 40 bar (600 PSI) non-shock cold working pressure
- -40°C to +170°C (-40°F to +350°F)
- For use with dangerous fluids temperature rating is -20°C +60°C and pressure rating is 5 bar
- AS4617 Limitation for GAS: 2100 Kpa up to 2" rated working pressure and 0°C / +60°C temperature
- **WARNING:** freezing of the fluid in the installation may severely damage the valve

Options

- Stem extension
- T-handle (for sizes 1/4" through 1 1/4")
- Oval lockable handle
- Stainless steel handle (1.4016 / AISI 430)
- Patented locking device
- Female by female threads
- Stubby handle
- **RuB** memory stop designed to be installed with our stubby handle

Upon request

- Stainless steel ball (1.4401 / AISI 316)
- Glass filled PTFE seals
- Custom design

PED Directive

- Assessment according to Pressure Equipment Directive 2014/68/UE module B+D by ICIM (0425)

Approved by or in compliance with

- The Australian Gas Association (Australia)
- Factory Mutual (United States)
- BSI Group (United Kingdom)
- RoHS Compliant (EU)

NOTE: approvals apply to specific configurations/sizes only.



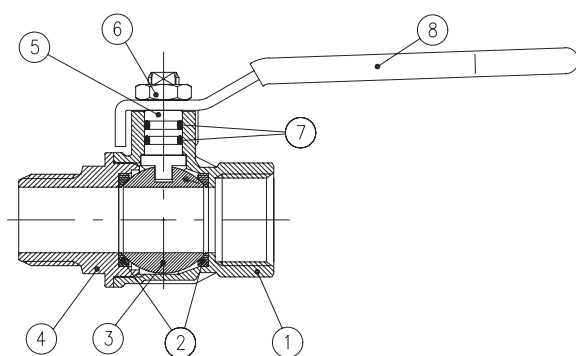

1 1/4"-2" hollow ball

Part description		Q.ty	Material
1	Nickel plated BSPT body (external nickel plated, unplated inside up to 2")	1	CW617N
2	Seat	2	PTFE
3	Chrome plated ball	1	CW617N
4	Nickel plated BSPT male end-cap (external nickel plated, unplated inside up to 2")	1	CW617N
5	Nickel plated stem O-ring design	1	CW617N
6	Geomet® nut	1	CB4FF (EN10263-2)
7	O-Ring	2	FPM
8	Yellow PVC coated Geomet® steel handle	1	DD11 (EN10111)

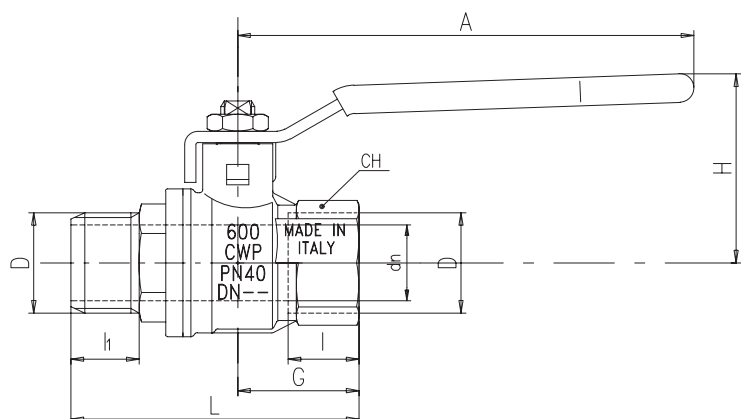

Compliant to
CE
2014/68/UE product
Equipment category III
Module B+D

Code	S84B52	S84C52	S84D52	S84E52	S84F52	S84G52	S84H52	S84I52
D (inch)	1/4"	3/8"	1/2"	3/4"	1"	1 1/4"	1 1/2"	2"
DN (mm)	8	10	15	20	25	32	40	50
I (mm)	12	12	15.5	17	21	23	23	26.5
II (mm)	13.5	13.5	16.5	18	22	24	24	27.5
L (mm)	56.5	56.5	70	76.5	92.5	106	113	133
G (mm)	22.5	22.5	29.5	32	40.5	46.5	51	60.5
A (mm)	82	82	100	120	120	158	158	158
H (mm)	38	38	43	50	54	73	79	86
CH (mm)	17	20	25	31	40	49	54	68.5

DN shows the nominal flow diameter. Actual flow diameter complies with full port DIN 3357 part 4. Ball valves are marked CE on handle from 1 1/4" to 2":

CE 0425 cat IIIB+D PS: 5 GAS TS1:-20°C TS2: +60°C

Pressure-temperature chart

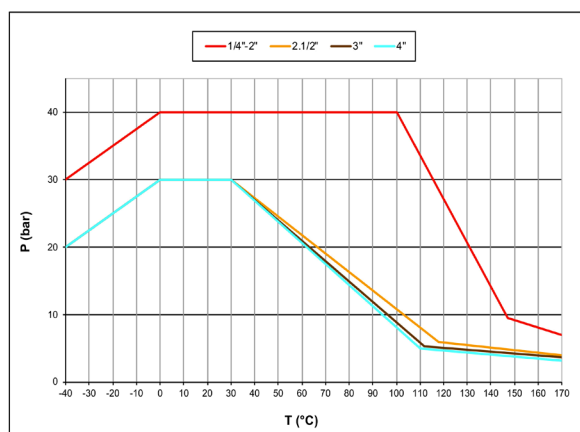

AS4617 limitations for GAS: 2100 Kpa up to 2" and 1500 Kpa from 2 1/2" to 4" rated working pressure and 0°C +60°C temperature

Pressure drop chart

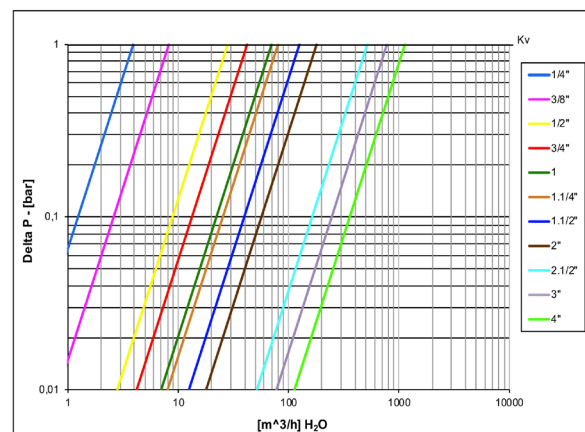

XCES84M - 0