

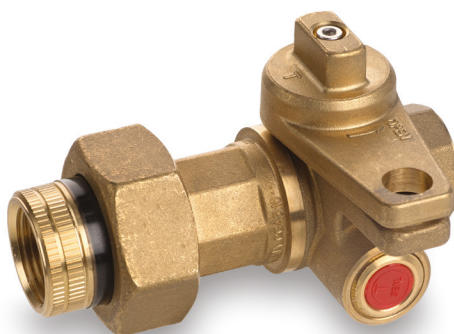

s.80 surepass

3/4" – 1" full port 175 psi bypassing gas meter valve

One quick turn switches valve from normal metered flow to bypass mode for rapid on-line servicing of meter or regulator.



Quality

- No metal-to-metal moving parts
- No maintenance or lubrication ever required
- Every valve production tested twice for internal or external leakage
- Meets all applicable parts to DoT 192
- Customer service never interrupted
- Chrome plated brass ball
- Gas theft discouraged by plastic security plug in bypass port and port inaccessible when barrel lock in use

Body

- Rust-proof forged brass body, ball, stem and locking

Stem

- Maintenance-free, double FPM O-rings at the stem for maximum safety, eliminate gas emissions

Sealing

- Pure PTFE seats with flexible-lip design

Threads

- NPT taper ANSI B1.20.1 female by dielectric union female threads

Flow

- Full port to DIN 3357 for maximum flow
- Full 100 SCFH gas flow during bypassing

Handle

- Tamper proof locking
- Single lever operation for positive switch from metering to bypassing

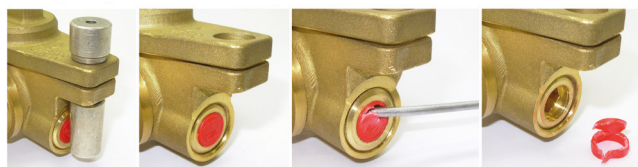

Tamper proof seal

Working pressure & temperature

- 175 PSI non-shock cold working pressure
- -40°F/ +350°F
- **WARNING:** freezing of the fluid in the installation may severely damage the valve

Options

- Painted gray
- By-pass hose assembly
- Dielectric union end long or short pattern

Approved by or in compliance with

- Canadian standards Association (United States, Canada)
- GOST-R (Russia)
- RoHS Compliant (EU)

NOTE: approvals apply to specific configurations/sizes only.

INSTALL HERE PART
NUMBER S80F43BL



SUREPASS BYPASS SYSTEM

Schematic Drawing
Showing Riser and Meter Set (black)
SurePass Ball Valves (blue)
ByPass Hole Assembly (magenta)

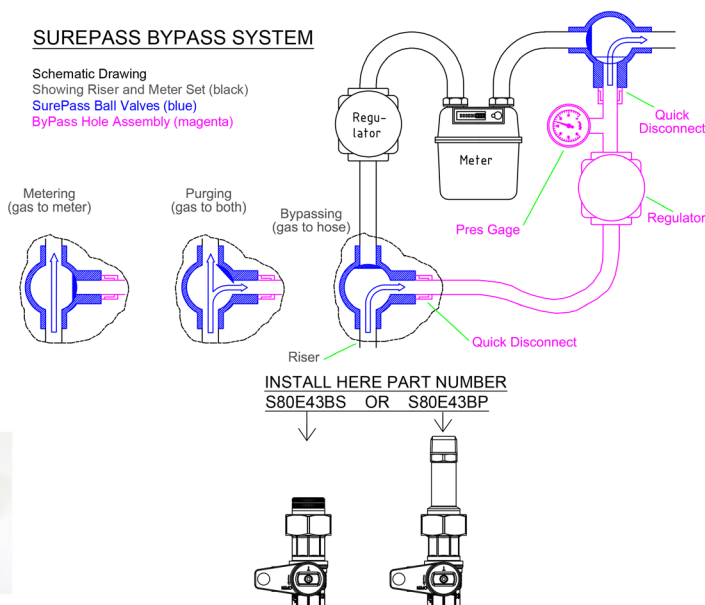

INSTALL HERE PART NUMBER
S80E43BS OR S80E43BP

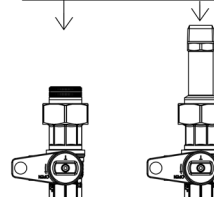

S80E43BS

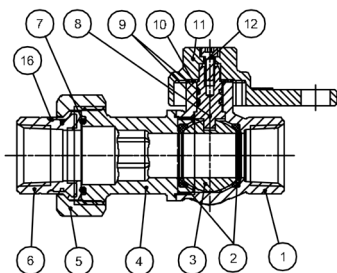

S80F43BL

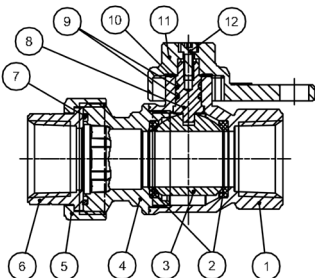

S80E43BP

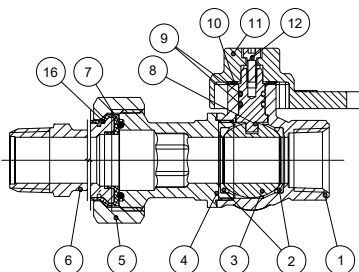

	Part description	Qty	Material
1	Sand blasted body	1	CW617N
2	Seat	2	PTFE glass filled 5-15%
3	Chrome plated ball	1	CW617N
4	Sand blasted end-cap	1	CW617N
5	Nut	1	CW617N
6	NPT female tail piece	1	CW617N
7	O-Ring	1	FPM
8	Stem O-Ring design	1	CW617N
9	O-Ring	2	FPM
10	Washer	1	PTFE glass filled 25%
11	Sand blasted lockwing	1	CW617N
12	Stainless steel screw	1	1.4301 / AISI304
13	Plug	1	CW617N
14	Security plug	1	Polystyrene
15	O-Ring	1	FPM
16	Insulation (for 3/4")	1	Polyamide

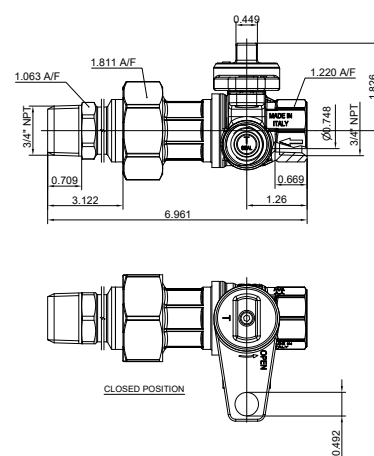
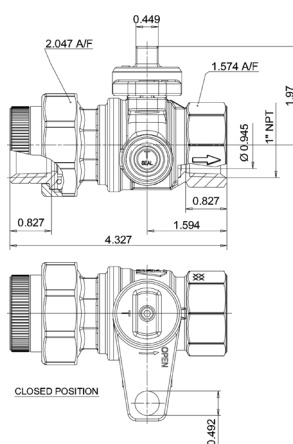
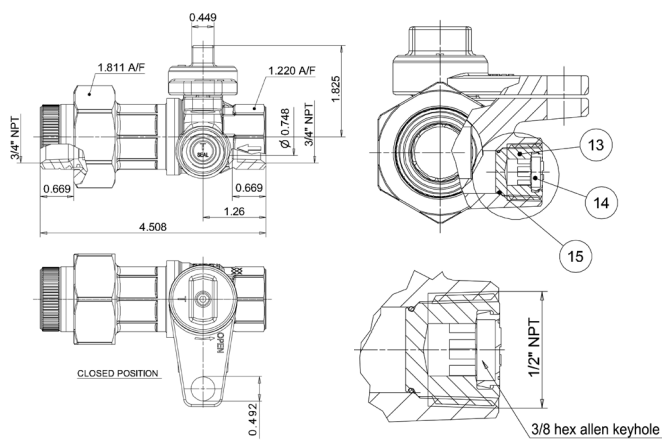

DN shows the nominal flow diameter. Actual flow diameter complies with full port DIN 3357 part 4.

