



s.115 sweat end

1/2"- 2" heavy pattern brass gate valve



Quality

- Suitable for water-works, domestic and agricultural installations
- Non rising stem suitable to most difficult applications

Body

- Low pressure drop
- Finely cast sand blasted heavy brass body

Stem

- High performance PTFE stem seal

Connections

- Solder end connections

Handle

- Strong cast aluminum hand-wheel
- **WARNING:** do not exceed reasonable temperature and/or electrical load

Working pressure & temperature

- 200 PSI (for solder joints rating see table 1) non-shock cold working pressure
- -4°F to +200°F (for solder joints rating see table 1)
- **WARNING:** freezing of the fluid in the installation may severely damage the valve

Options

- s.114 NPT female by female taper threads

Approved by or in compliance with

- GOST-R (Russia)

NOTE: approvals apply to specific configurations/sizes only.



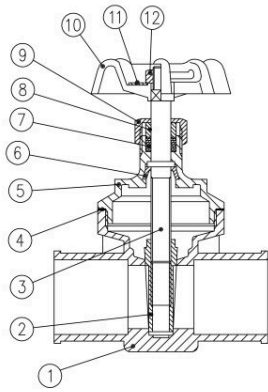

	PART DESCRIPTION	Q.TY	MATERIAL
1	Body	1	CW617N
2	Gate	1	CW617N
3	Stem	1	CW617N
4	Body cap sealing	1	PTFE
5	Cap	1	CW617N
6	Stem ring	1	CW617N
7	Packing gland seal	1	PTFE
8	Packing gland	1	CW617N
9	Packing gland nut	1	CW617N
10	Red round handle	1	Steel
11	Disc	1	Aluminum
12	Handle nut	1	CW617N

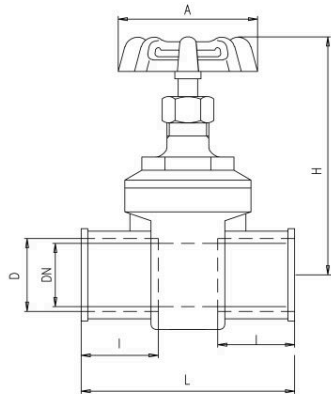

Code		115D00	115E00	115F00	115G00	115H00	115I00
D (inch)	Nominal	1/2	3/4	1	1 1/4	1 1/2	2
	actual	0.630	0.878	1.130	1.378	1.630	2.130
DN (inch)		0.500	0.748	1	1.248	1.5	2
I (inch)		0.492	0.748	0.905	0.964	1.102	1.338
L (inch)		1.772	2.362	2.716	3.031	3.386	4.016
A (inch)		2.165	2.165	2.362	2.835	3.150	3.937
H (inch)		2.815	3.130	3.661	4.331	4.862	6.083
PSI		200	200	200	200	200	200

Pressure - Temperature Ratings										
Joining material	melting range degrees		working temperature degrees		maximum working gauge pressure					
	°F	°C	°F	°C	size 1/2"-1"		size 1.14"-2"		size 2.1/2"-4"	
					psi	kPa	psi	kPa	psi	kPa
50-50 tin-lead solder* ASTM B32 alloy grade 50A	361/421	185/215	0/+100	-18/+38	200	1400	175	1200	150	1050
			0/+150	-18/+66	150	1050	125	850	100	700
			0/+200	-18/+93	100	700	90	600	75	500
			0/+250	-18/+121	85	600	75	500	50	350
95-5 tin-antimony solder ASTM B32 alloy grade 95TA	450/464	230/240	0/+100	-18/+38	500	3500	400	2800	300	2100
			0/+150	-18/+66	400	2800	350	2400	275	2000
			0/+200	-18/+93	300	2100	250	1700	200	1400
			0/+250	-18/+121	200	1400	175	1200	150	1050

Above stated limits are not imposed by the valve, but by the strength of the soldering joint according to ASME B16.22.

*This alloy contains more than 0.2% lead and, according to certain specifications, cannot be used for potable water or other foods.