

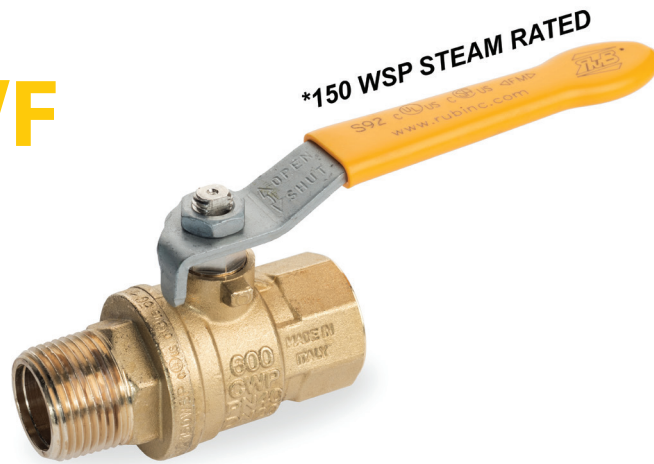

s.92 NPT M/F

1/2" - 2"
packing gland



Quality

- 24h 100% seal test guaranteed
- Dual sealing system allows valve to be operated in either direction making installation easier
- No metal-to-metal moving parts
- Handle clearly shows ball position
- Silicone-free lubricant on all seals
- Chrome plated brass ball for longer life
- Handle stops on body to avoid stress at stem

Body

- Hot forged sand blasted, unplated brass body and cap sealed with Loctite® or equivalent thread sealant
- Finest brass according to EN 12165 and EN 12164 specifications

Stem

- Blowout-proof nickel plated brass stem
- Pure PTFE adjustable packing gland and reinforced washer for lower torque and easy maintenance
- Triple stem seals in sizes over 2"

Sealing

- Glass filled pure PTFE self-lubricating seats with flexible-lip design

Threads

- NPT taper ANSI B.1.20.1 male by female threads

Flow

- Full port to DIN 3357 for maximum flow

Handle

- Geomet® carbon steel handle with thick PVC dip coating. Handle coating offers both thermal and electrical protection
- **WARNING:** do not exceed reasonable temperature and/or electrical load

Working pressure & temperature

- 600 PSI (40 bar) up to 2", 450 PSI (30 bar) over 2", (150 WSP -10 bar all sizes) non-shock cold working pressure
- 250 PSI (17 bar) non-shock working pressure for LP-Gas
- *150 psig (10 bar) non-shock steam working pressure. Not suitable for throttling steam
- -40°F/+366°F (-40°C / +185°C)
- **WARNING:** freezing of the fluid in the installation may severely damage the valve

Options up to 2" size

- Stem extension
- T-handle
- Stainless steel handle (1.4016 / AISI 430)
- Oval lockable handle up to 2", round over 2"
- Patented locking device for valves up to 4"
- Female by female NPT threads up to 4"
- Stubby handle

Upon request

- Stainless steel ball and/or stem (1.4401 / AISI 316)
- Custom design
- Pure PTFE seals

Approved by or in compliance with

- Canadian standards Association (United States, Canada)
- Factory Mutual (United States)
- GOST-R (Russia)
- RoHS Compliant (EU)
- Meeting WW-V-35C Federal U.S. Specification (United States)
- Underwriters Laboratories (United States, Canada):
 - Guide YSDT: LP-Gas shut-off valve
 - Guide YRBX: Flammable liquid shut-off valve
 - Guide YRPV: Gas shut-off valve for use with natural and manufactured gases
 - Guide MHKZ: No. 6 oil at 250°F

NOTE: approvals apply to specific configurations/sizes only.



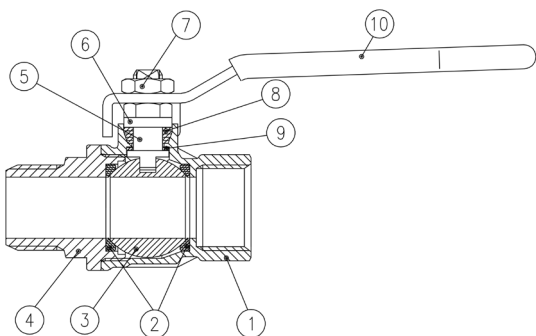

1 1/4"-2" hollow ball

| | Part description | Qty | Material |
|----|---|-----|-------------------------|
| 1 | Unplated body | 1 | CW617N |
| 2 | Seat | 2 | PTFE glass filled 5-15% |
| 3 | Chrome plated ball | 1 | CW617N |
| 4 | Unplated NPT end-cap | 1 | CW617N |
| 5 | Nickel plated stem packing gland design | 1 | CW617N |
| 6 | Nickel plated gland nut | 1 | CW617N |
| 7 | Geomet® nut | 1 | CB4FF (EN10263-2) |
| 8 | Packing gland seal | 1 | PTFE |
| 9 | Washer | 1 | PTFE carbon filled 25% |
| 10 | Yellow PVC coated Geomet® steel handle | 1 | DD11 (EN10111) |

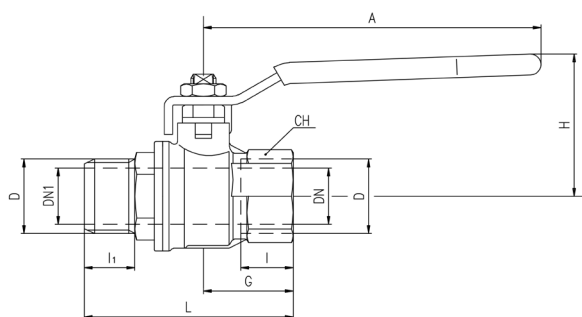

| Code | S92B42 | S92C42 | S92D42 | S92E42 | S92F42 | S92G42 | S92H42 | S92I42 | S92L42 | S92M42 | S92N42 |
|------------|--------|--------|--------|--------|--------|--------|--------|--------|--------|--------|--------|
| D (inch) | 1/4 | 3/8 | 1/2 | 3/4 | 1 | 1 1/4 | 1 1/2 | 2 | 2 1/2 | 3 | 4 |
| DN (inch) | 0.314 | 0.393 | 0.590 | 0.787 | 0.984 | 1.259 | 1.574 | 1.968 | 2.559 | 3.149 | 3.937 |
| DN1 (inch) | 0.314 | 0.393 | 0.590 | 0.787 | 0.984 | 1.259 | 1.574 | 1.968 | 2.205 | 2.756 | 3.701 |
| I (inch) | 0.472 | 0.472 | 0.610 | 0.669 | 0.826 | 0.905 | 0.905 | 1.043 | 1.260 | 1.377 | 1.633 |
| I 1 (inch) | 0.531 | 0.531 | 0.650 | 0.709 | 0.866 | 0.945 | 0.845 | 1.083 | 1.457 | 1.555 | 1.732 |
| L (inch) | 2.224 | 2.224 | 2.756 | 2.992 | 3.642 | 4.173 | 4.449 | 5.236 | 7.106 | 8.051 | 9.370 |
| G (inch) | 0.885 | 0.885 | 1.161 | 1.259 | 1.594 | 1.830 | 2.007 | 2.381 | 3.070 | 3.484 | 4.252 |
| A (inch) | 3.228 | 3.228 | 3.937 | 4.724 | 4.724 | 6.220 | 6.220 | 6.220 | 10.039 | 10.039 | 10.039 |
| H (inch) | 1.563 | 1.563 | 1.695 | 1.988 | 2.153 | 2.988 | 3.236 | 3.500 | 5.196 | 5.511 | 6.062 |
| CH (inch) | 0.669 | 0.787 | 0.984 | 1.220 | 1.574 | 1.929 | 2.125 | 2.696 | 3.346 | 3.897 | 4.921 |
| Cv (GPM) | 4.5 | 9.5 | 32.3 | 48.5 | 80.9 | 92.4 | 144.4 | 206.8 | 596.2 | 896.5 | 1305.5 |

DN shows the nominal flow diameter. Actual flow diameter complies with full port DIN 3357 part4. Stem configuration of valves over 2" is slightly different.

Pressure-temperature chart

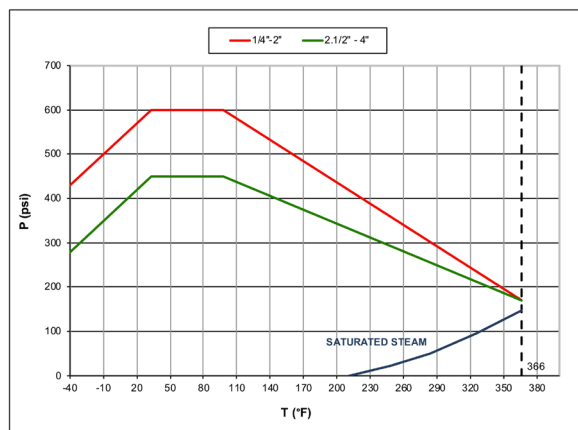

Pressure drop chart

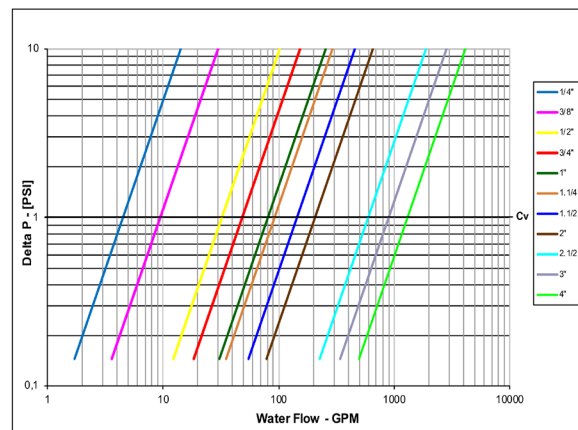

XCES92M - 4711