



s.126 M NPT

1/2" - 2"

NPT swing check valve with metal seals



Quality

- Suitable for domestic, industrial, pneumatic and hydraulic installations
- Robust construction
- Inspection cap

Body

- Hot forged brass body

Sealing

- Metal to metal sealing

Threads

- NPT taper ANSI B.1.20.1 female by female threads

Working pressure & temperature

- 145 psi (10 bar) non-shock cold working pressure
- +32°F to +212°F (0°C to +100°C)
- **WARNING:** freezing of the fluid in the installation may severely damage the valve

Options

- Configuration with ISO228 female parallel threads and rubber seals from 3/8" up to 2" (s.126)
- Configuration with ISO228 female parallel threads and metal seals from 3/8" up to 2" (s.126M)

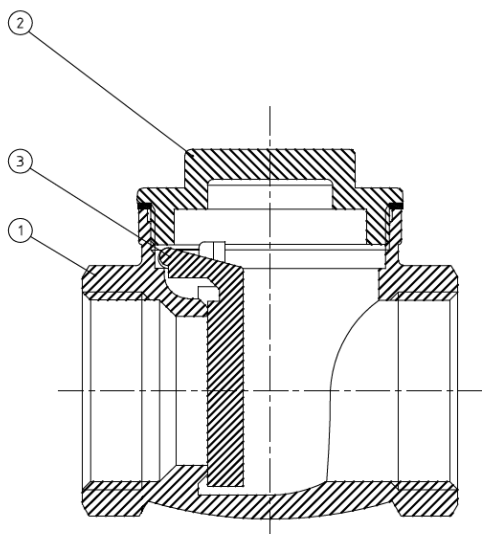

	Part description	Q.ty	Material
1	Unplated body	1	CW617N
2	Unplated bonnet	1	CW617N
3	Unplated sealing disc	1	CW617N

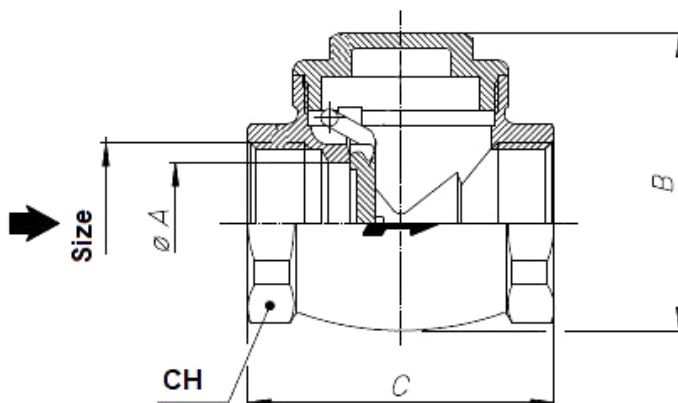

Code	126D4M	126E4M	126F4M	126G4M	126H4M	126DI4M
Size (inch)	1/2"	3/4"	1"	1 ¼"	1 ½"	2"
ØA (inch)	0,59	0,78	0,98	1,29	1,45	1,85
B (inch)	1,81	2,00	2,40	2,87	3,34	3,70
C (inch)	1,85	2,08	2,48	2,91	3,42	3,81
CH (inch)	0,98	1,22	1,49	1,85	2,12	2,63
PN (psi)	145	145	145	145	145	145