

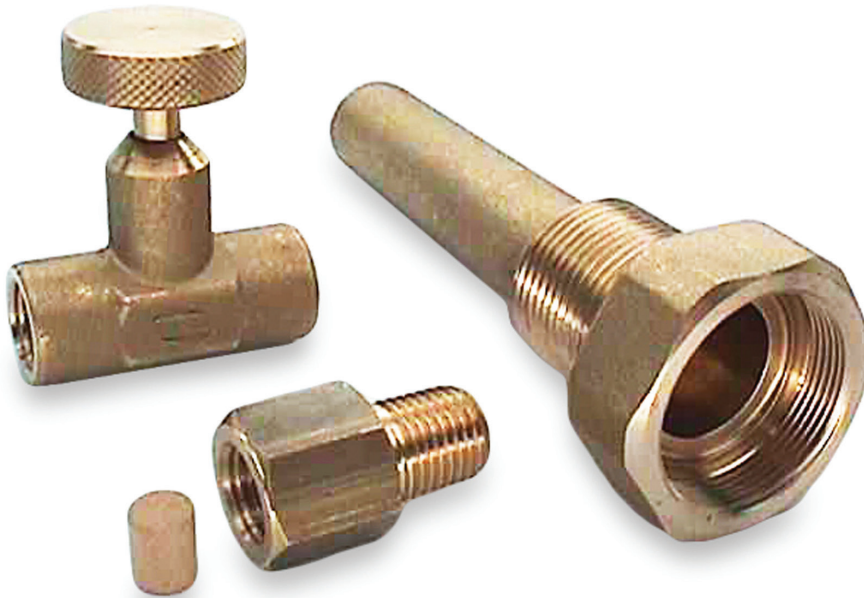

Instrumentation package



- 1/4" needle valve (2000 PSI), #SNI7352
- 1.1/4" thermometer well (1000 PSI), #PNI34F2
- 1/4" snubber (1000 PSI), #SNI8722

For descriptions, applications and drawings see reverse.

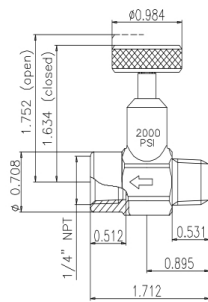
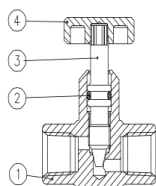
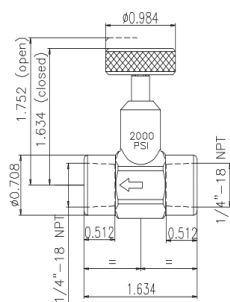

Needle valve:

- 2000 PSI (CWP)
- One piece body construction
- Forged brass body
- Fip x Fip NPT threads
- Temp range -40°F to +350°F
- FPM stem seal design

Applications include shut off and throttling for pressure gauges and instruments

Needle Valve Part description		Q.ty	Material
1	Unplated valve body	1	CW617N
2	O-Ring	1	FPM
3	Retainer	1	CW617N
4	Handwheel	1	CW617N

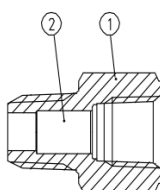
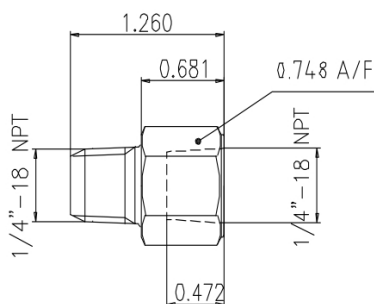

Snubber:

- 1000 PSI (CWP)
- Forged brass with bronze core
- Temp range -40°F to +350°F

Installed on gauges and instruments where pressure pulsations are present.

The snubber is used to damp the pulsations, giving more stable readings and reducing instrument wear.

Snubber Part description		Q.ty	Material
1	Unplated body	1	CW617N
2	Bronze core	1	Bronze

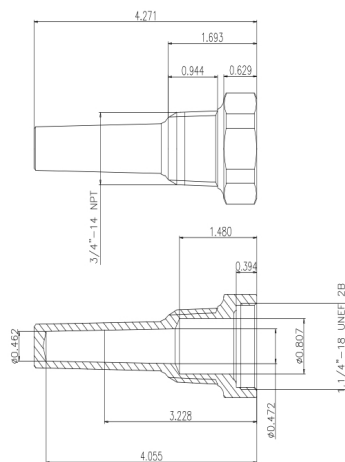

Thermometer well:

- 1000 PSI (CWP)
- Forged brass construction
- Meets Fed. Spec GG-T-321
- Meets SAMA RC-17-10

Installed on gauges and instruments where pressure pulsations are present. The snubber is used to damp the pulsations, giving more stable readings and reducing instrument wear.

Well Part description		Q.ty	Material
1	Unplated body	1	CW617N