



s.135

stainless steel

2" - 3" - 4"
ANSI B16.5 flange
ISO 5211



Quality

- Anti-static device
- Locking device
- Long cycle life
- Test standard: API 598
- API 607 4th edition fire safe approval
- Vacuum service to 29" Hg

Body

- ISO 5211 actuator mounting pad
- Body: ASTM A351 Gr. CF8M

Stem

- Blow-out proof stem design
- Adjustable stem packing



Sealing

- ME-PTFE seal kits:
 - replaces PTFE, RPTFE and FPA
 - low deformation under load
 - low permeation

Connections

- ANSI B16.5, B16.10 and B16.34 full compliance

Handle

- Handle in ASTM A536 Gr. 65-45-12
- **WARNING:** do not exceed reasonable temperature and/or electrical load

Working pressure & temperature

- General use: 52 bar (see chart on reverse)
- 19 bar for ASME 150 CF8M (see chart on reverse)
- Steam rating: 10 bar
- -45,5°C to +246°C
- **WARNING:** freezing of the fluid in the installation may severely damage the valve

Approved by or in compliance with

- GOST-R (Russia)

NOTE: approvals apply to specific configurations/sizes only.

Part description	Q.ty	Material
1	1	ASTM A351-CF8M
2	1	ASTM A351-CF8M
3	1	ASTM A351-CF8M
4	1	ASTM A276 Gr. 316
5	2	ME-PTFE*
6	1	ME-PTFE*
7	1	ME-PTFE*
8	1	ME-PTFE*
9	1	ASTM A351-CF8
10	1	SS304
11	2	SS304
12	2	ASTM A193 Gr. B8
13	1	ASTM A536 Gr. 65-45-12

"A" VIEW

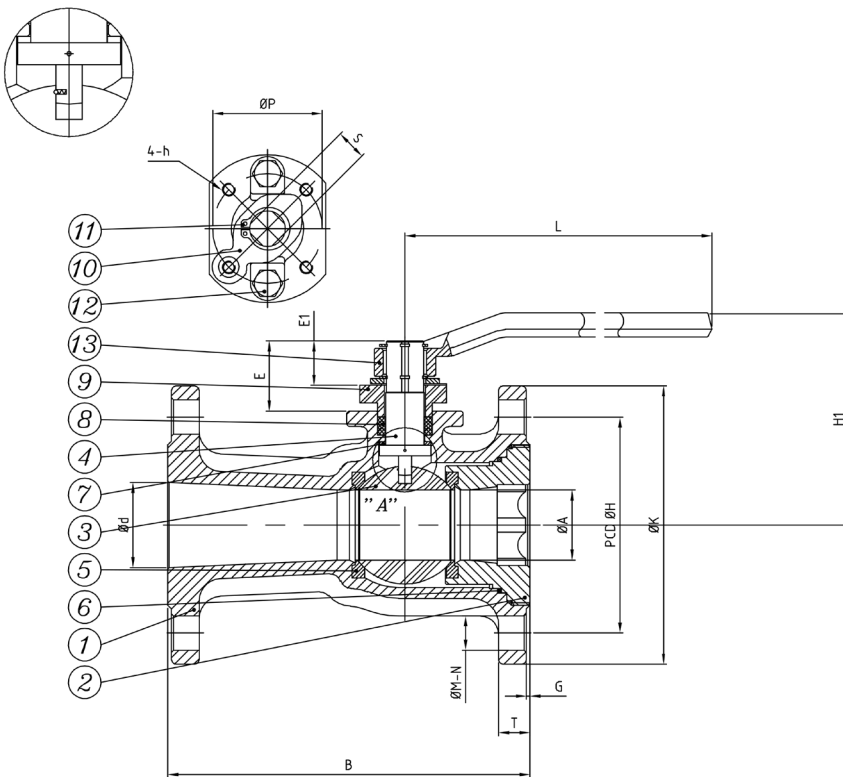

Code	135IF0	135MF0	135NF0
Size (inch)	2"	3"	4"
A (mm)	38.1	65	80
B (mm)	177.8	203.2	228.6
E (mm)	41.9	55.9	55.9
E1 (mm)	25.9	36.6	36.6
d (mm)	50	80	100.1
G (mm)	1.5	1.5	1.5
H (mm)	120.7	152.4	190.5
K (mm)	152.4	190.5	228.6
T (mm)	15.7	19.1	23.8
M (mm)	19.1	19.1	19
N	4	4	8
P (mm)	70.1	102.1	102.1
S (mm)	17	22.1	22.1
L (mm)	231.9	326.9	326.9
H1 (mm)	126	151.9	160
h	M8*P1.25	M10*P1.5	M10*P1.5

SIZE	2"	3"	4"
Kv Factor	146	370	486

Pressure-temperature chart

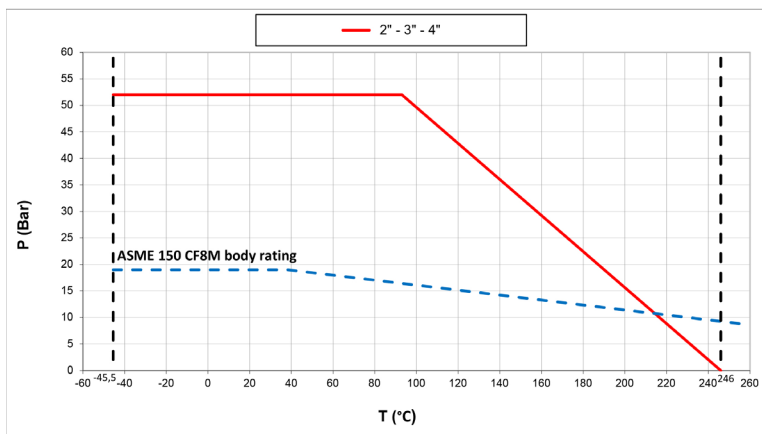

*ME-PTFE is molecular enhanced PTFE