



## s.101 3-way 4 seats L-port

1/4" - 2" ISO 228



### Quality

- Chrome plated brass ball for longer life
- UNI 8858 cycle and torque tests performed

### Body

- Hot forged sand blasted nickel plated brass body and caps
- 3- way L design allows complete range of flow handling applications
- Copper alloy brass according to EN 12165 and EN 12164 specifications

### Stem

- Maintenance-free, double two NBR O-rings at the stem for maximum safety

### Sealing

- Four seats design limits mixture among various fluids in the system
- PTFE seats

### Threads

- ISO 228 female threads

### Flow

- Extra port for lowest pressure drop

### Working pressure & temperature

- See non- shock cold working pressure on chart
- -10°C to + 120°C (+15°F to +250°F)
- **WARNING:** freezing of the fluid in the installation may severely damage the valve

### PED directive

- The product described in this document meets the requirements of PED Directive 2014/68/UE and according to art.4 par.3, it does not require CE marking; it cannot be used with dangerous gases in sizes larger than 25mm; it cannot be used with non-dangerous gases in size larger than 32 mm

### Approved by or in compliance with

- GOST-R (Russia)

**NOTE:** approvals apply to specific configurations/ sizes only.

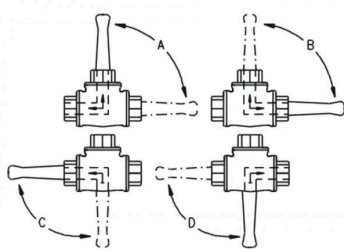

s.101 3-way L port

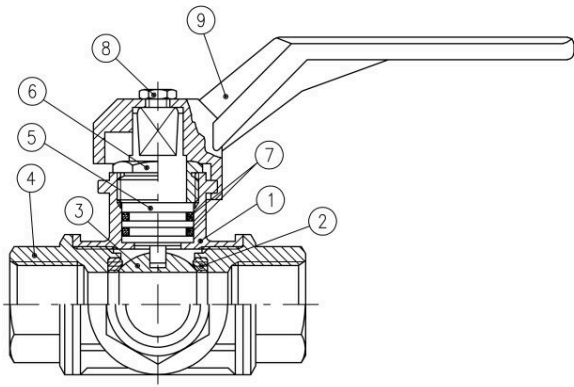

	PART DESCRIPTION	Q.TY	MATERIAL
1	Nickel plated body	1	CW617N
2	Seat	4	PTFE
3	Chrome plated ball	1	CW617N
4	Nickel plated end-cap	3	CW617N
5	Nickel plated stem O-ring design	1	CW614N
6	Nickel plated nut	1	CW614N
7	O-Ring	2	NBR
8	Screw	1	Steel
9	Red handle	1	Aluminum

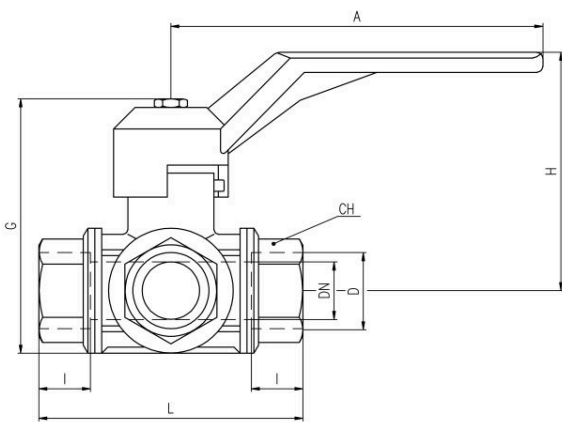

Code	101B00	101C00	101D00	101E00	101F00	101G00	101H00	101I00
D (inch)	1/4	3/8	1/2	3/4	1	1 1/4	1 1/2	2
DN (mm)	10	12	14	18	23	29	36	45
I (mm)	19	19	19	23	25	27	31	36
L (mm)	77	77	77	92	104	118	138	162
G (mm)	75	75	75	91	105	115	128	165
A (mm)	125	125	125	145	170	170	170	260
H (mm)	65	65	65	83	96	102	109	139
CH (mm)	22	22	27	34	41	50	57	70
Kv (m3/h)	1.5	2.5	3.5	7.0	12	19.5	37	52

**Pressure-temperature chart**

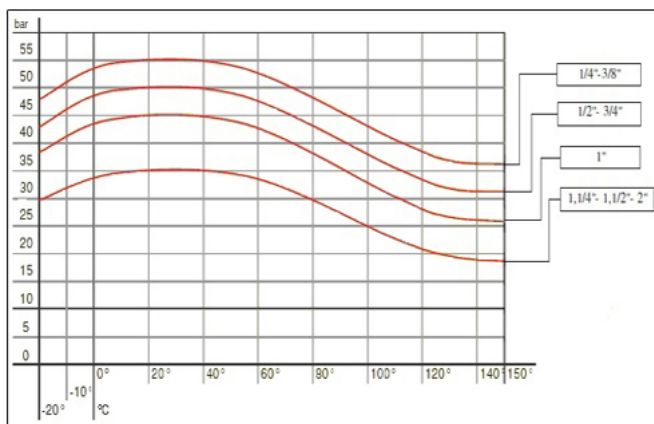

**Pressure drop chart**

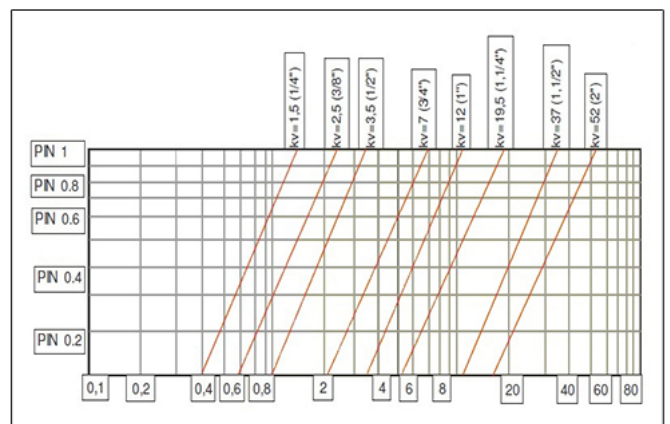

Ask for additional information on the whole range of **RUB** products and consult with your supplier for special applications.  
For complete disclaimer: [www.rubvalves.com/disclaimer](http://www.rubvalves.com/disclaimer)